

Model 993B Series Premium, Triaxial Accelerometers

FEATURES:

- Rugged design
- Hermetic
- Broad Frequency Response
- Easy to mount
- EMI/RFI protection
- ESD protection
- Reverse wire protection
- Low Noise
- Low weight

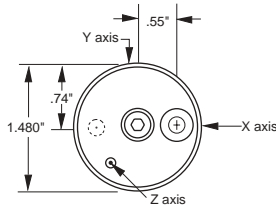

Top View

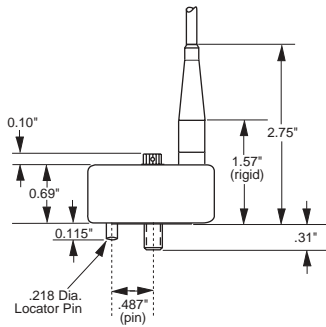

Side View

DYNAMIC	993B-5	993B-6	993B-7
Sensitivity, $\pm 10\%$, 25°C	25 mV/g	50 mV/g	100 mV/g
Acceleration Range	150 g peak	75 g peak	40 g peak
Amplitude Nonlinearity	1%		
Frequency Response:			
Z Axis ± 3 dB	2 - 10,000 Hz	—	—
X & Y Axis ± 3 dB	2 - 7,000 Hz	—	—
Transverse Sensitivity, max.	7% of axial	—	—
Temperature Response	-50°C	-10%	
.....	+120°C	+15%	

ELECTRICAL

Power Requirement: voltage source	18 - 30 VDC	—	—
current regulating diode ..	2 - 5 mA	—	—
Electrical Noise, equiv. g:			
Broadband 2.5 Hz to 25 kHz	336 μ g	220 μ g	160 μ g
Spectral			
10 Hz	24 μ g/√Hz	15 μ g/√Hz	10 μ g/√Hz
100 Hz	3.2 μ g/√Hz	2.0 μ g/√Hz	1.4 μ g/√Hz
1000 Hz	2 μ g/√Hz	1.1 μ g/√Hz	1.0 μ g/√Hz
Output Impedance, max.	400 Ω	—	—
Bias Output Voltage	11 VDC	—	—
Grounding	case isolated, internally shielded		

ENVIRONMENTAL

Temperature Range	-50 to 120°C
Vibration Limit	500 g peak
Shock Limit	5,000 g peak
Electromagnetic Sensitivity, equiv. g.	100 μ g/gauss
Sealing	Hermetic
Base Strain Sensitivity, max	0.0005 g/ μ strain
Hydrostatic Pressure, max	100 psi

PHYSICAL

Sensing Element Design	PZT ceramic / shear
Weight	134 grams
Case Material	316L stainless steel
Mounting	1/4 - 28 captive screw
Mating Connector	Not applicable
Integral Cabling	J12, 16 ft.

FUNCTION	CABLE CONDUCTOR COLOR
axis X, power / signal	Green
axis Y, power / signal	Red
axis Z, power / signal	White
common (all channels)	Black
N/C	Shield

ACCESSORIES SUPPLIED: #11714-07 captive screw (International customers specify mounting requirements); Calibration data (level 3).

